



Installation instructions for PZ4AL-3004-00
Under Run Protective Shield Engine Bay

TOYOTA LC 200



LEXUS LX



	LC 200	LX 570	LX 450d
Model year:	2015	2015	2015
Applicability:	VDJ200L-GMTVZW URJ202L-GMTEKW URJ202L-GNTVKW	URJ201L-GNZGKW	VDJ201L-GMTGZW
Part Number:			Aluminium: PZ4AL-3004-00
 Weight:			10.68 kg
 Installation Time:			30 min

PZ4AL-03004-00

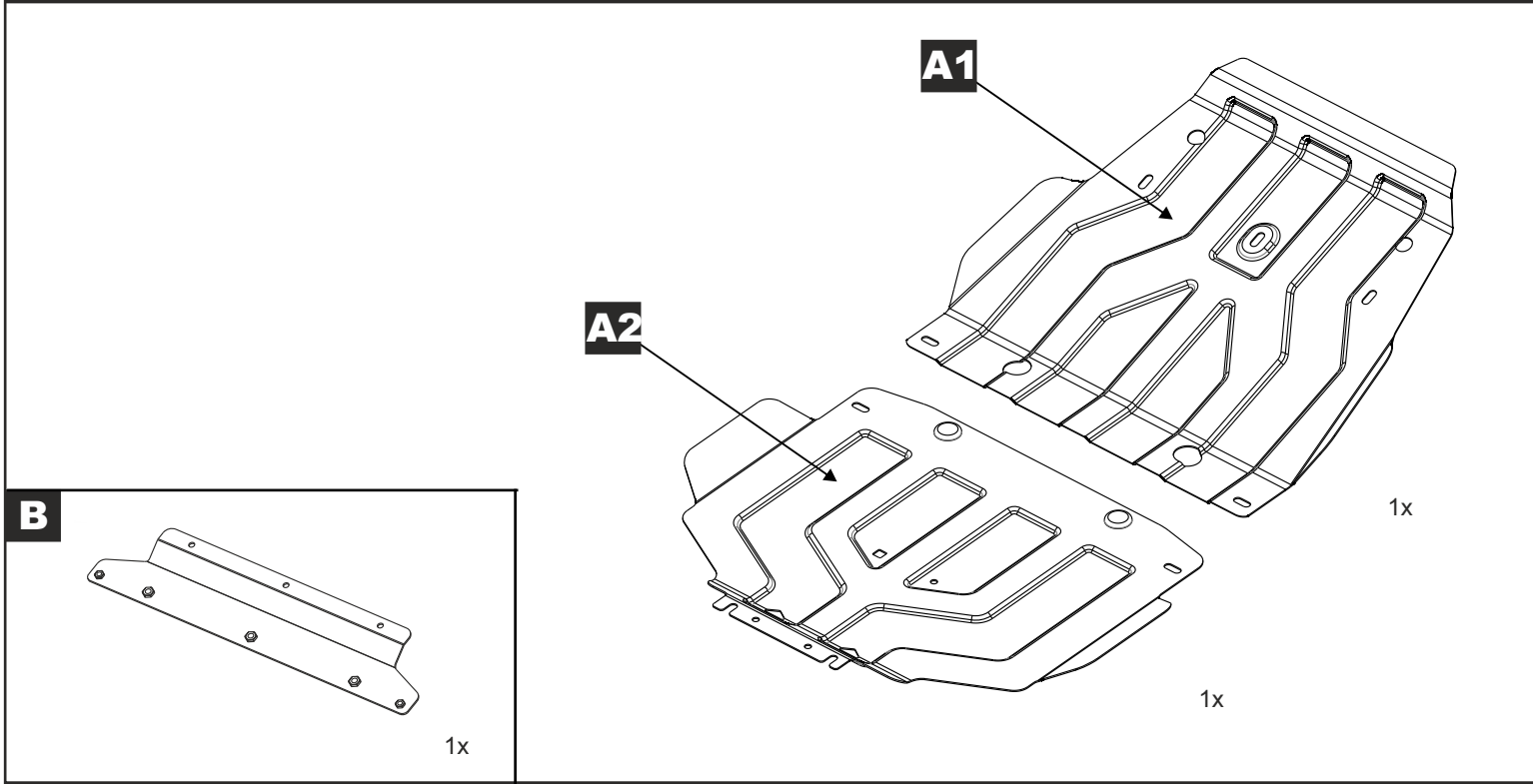

PZ4AL-01871-60

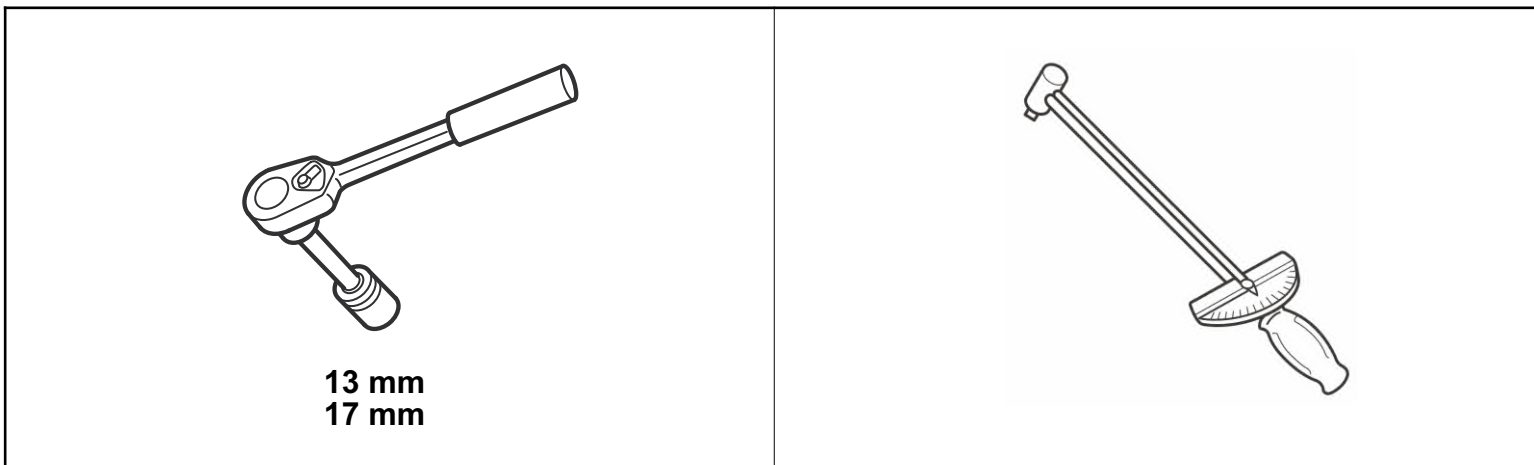
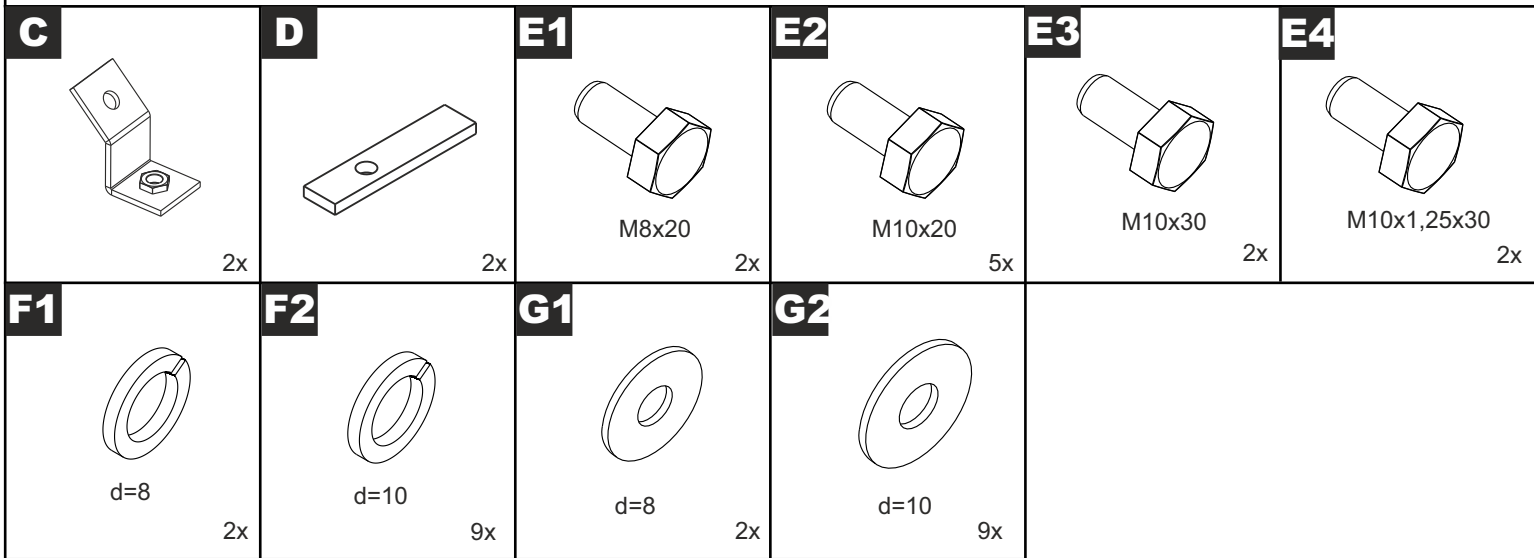

1

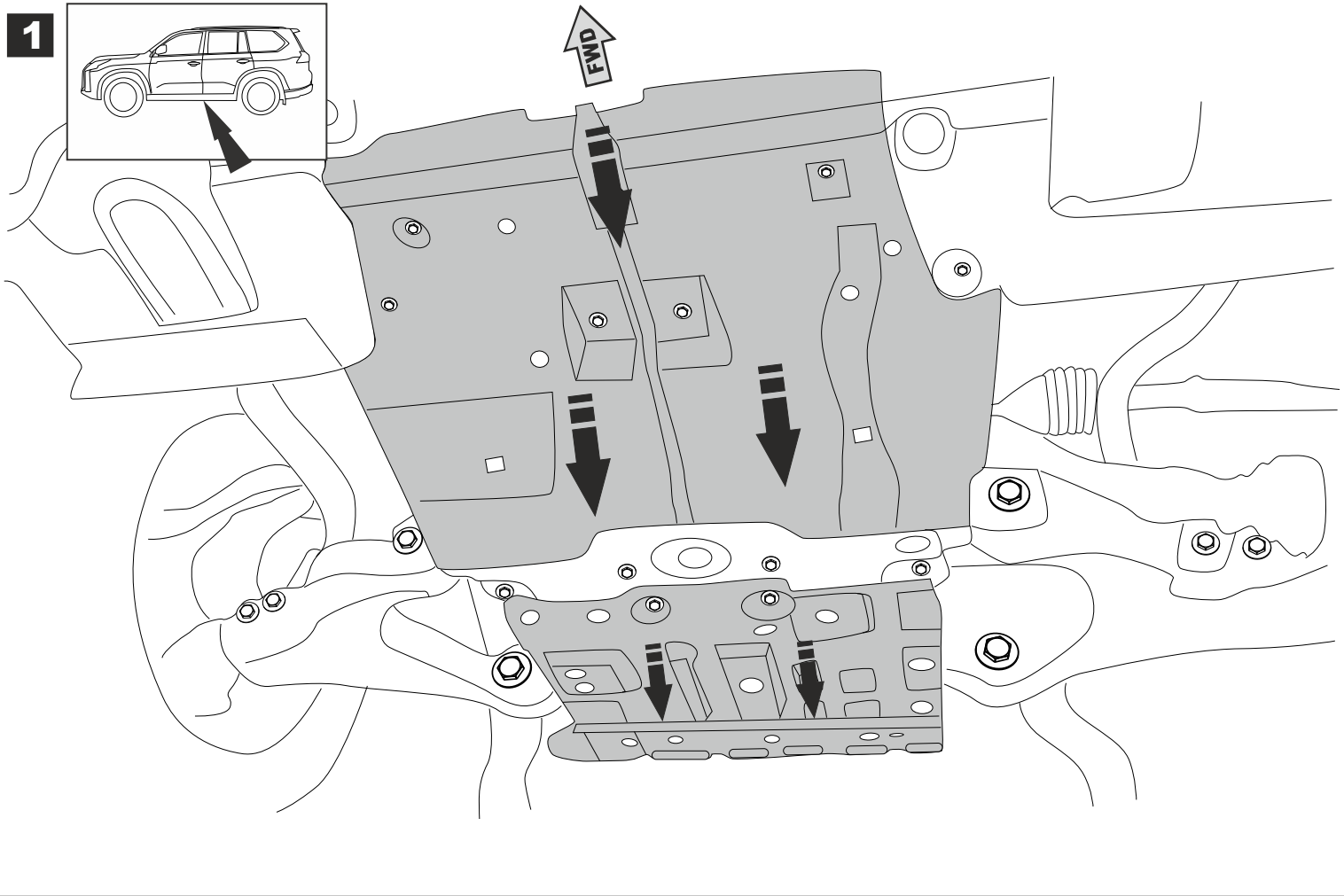

2

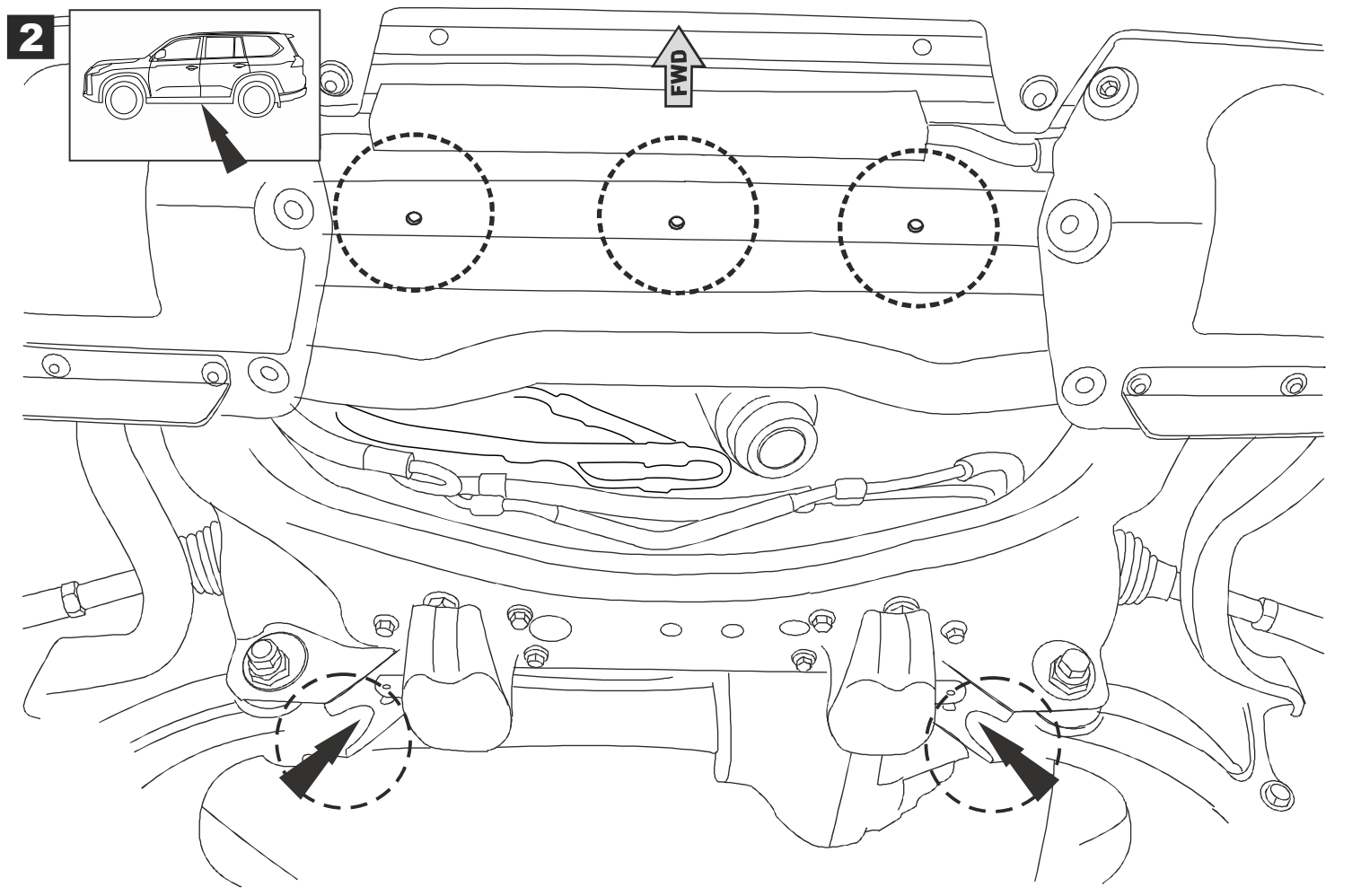

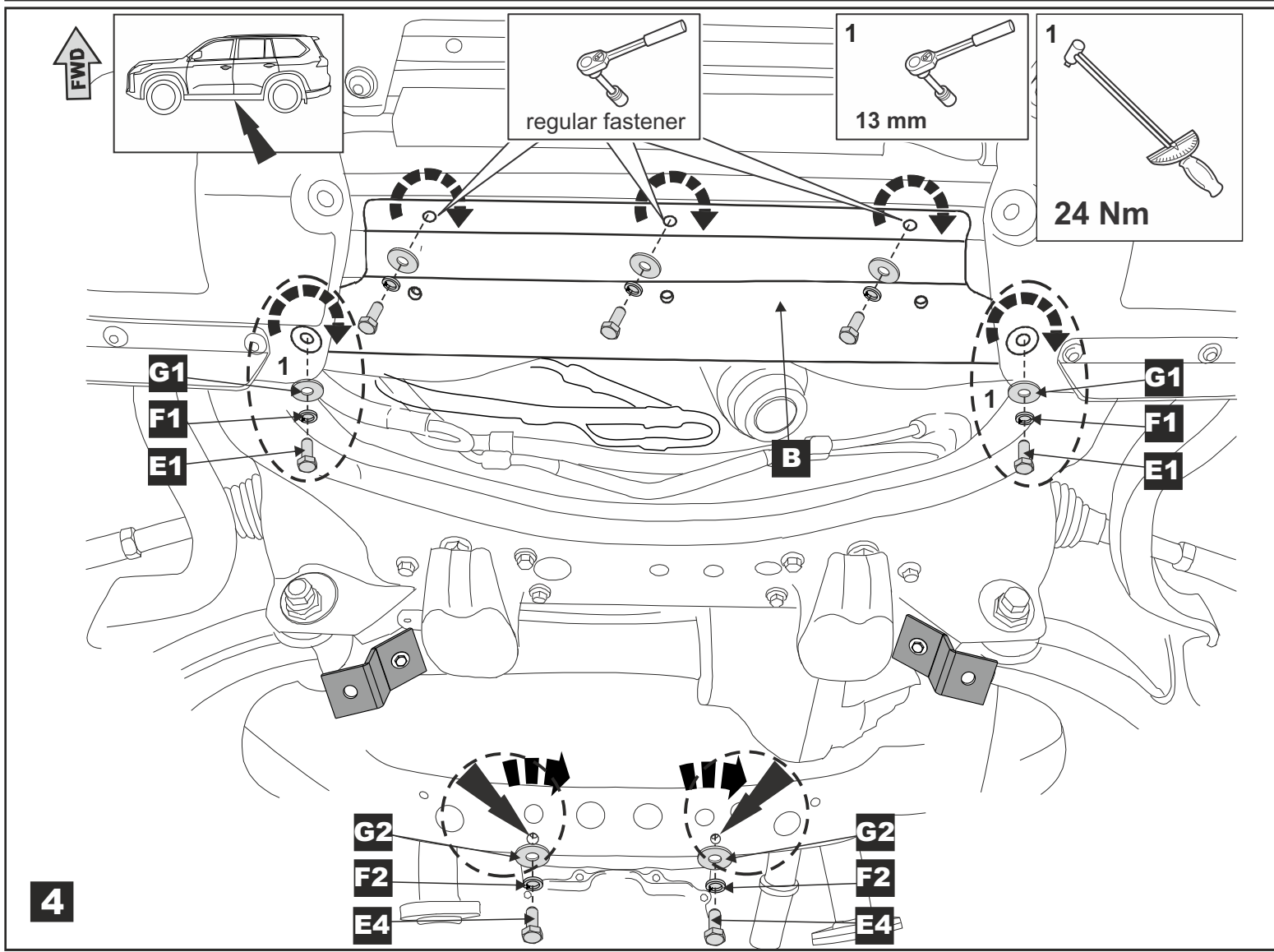
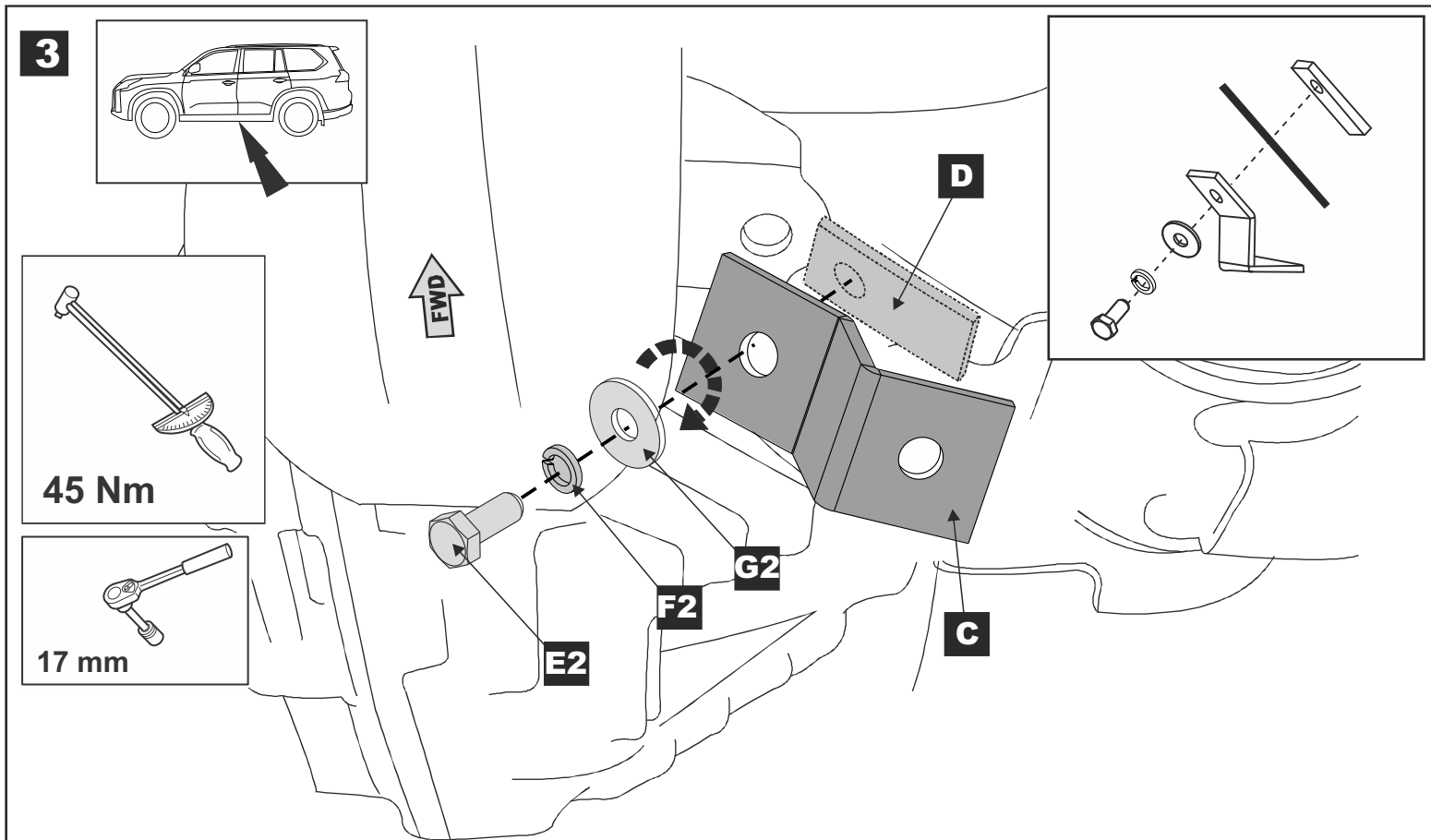

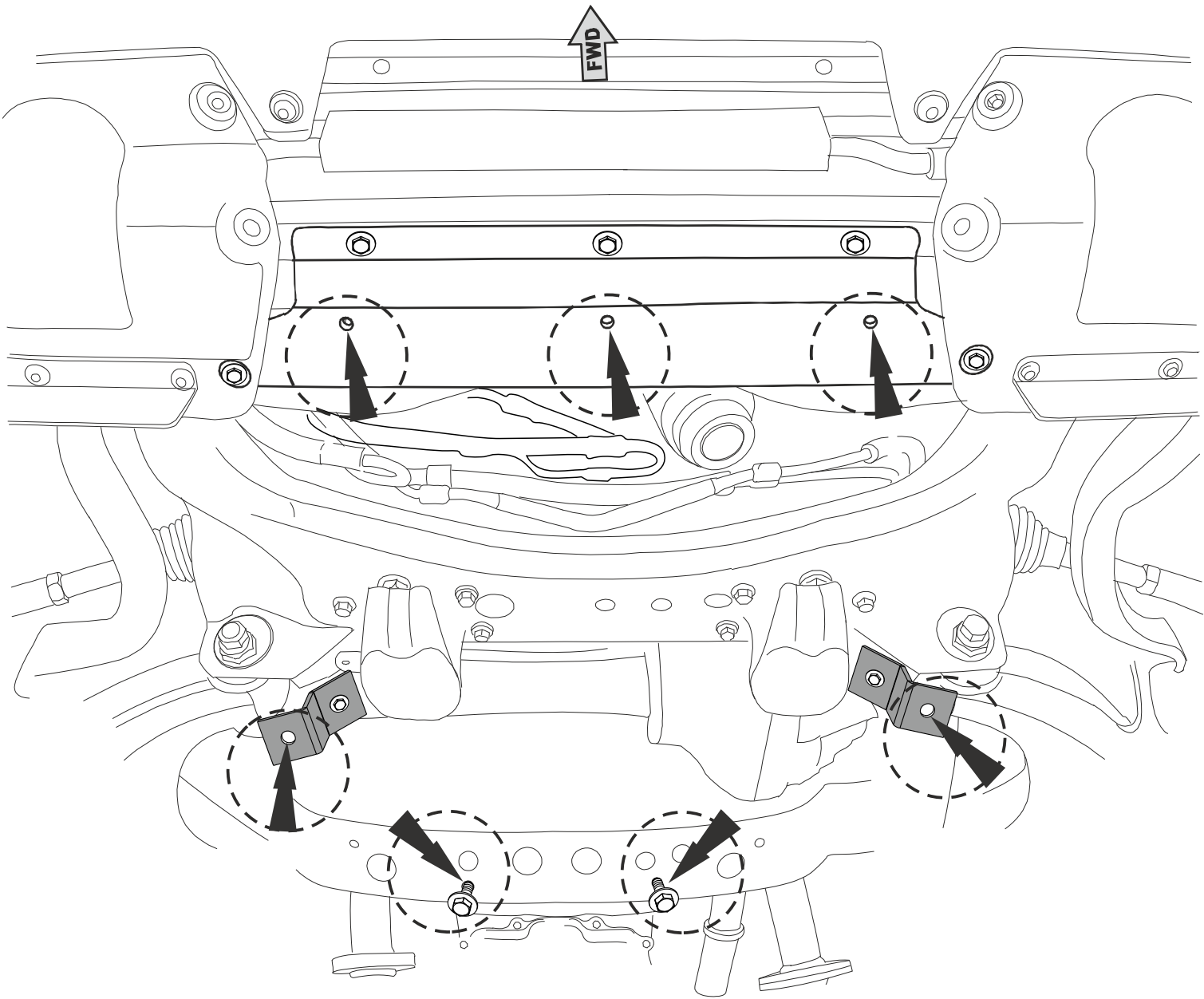
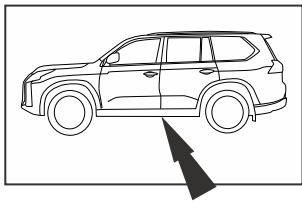

5

6

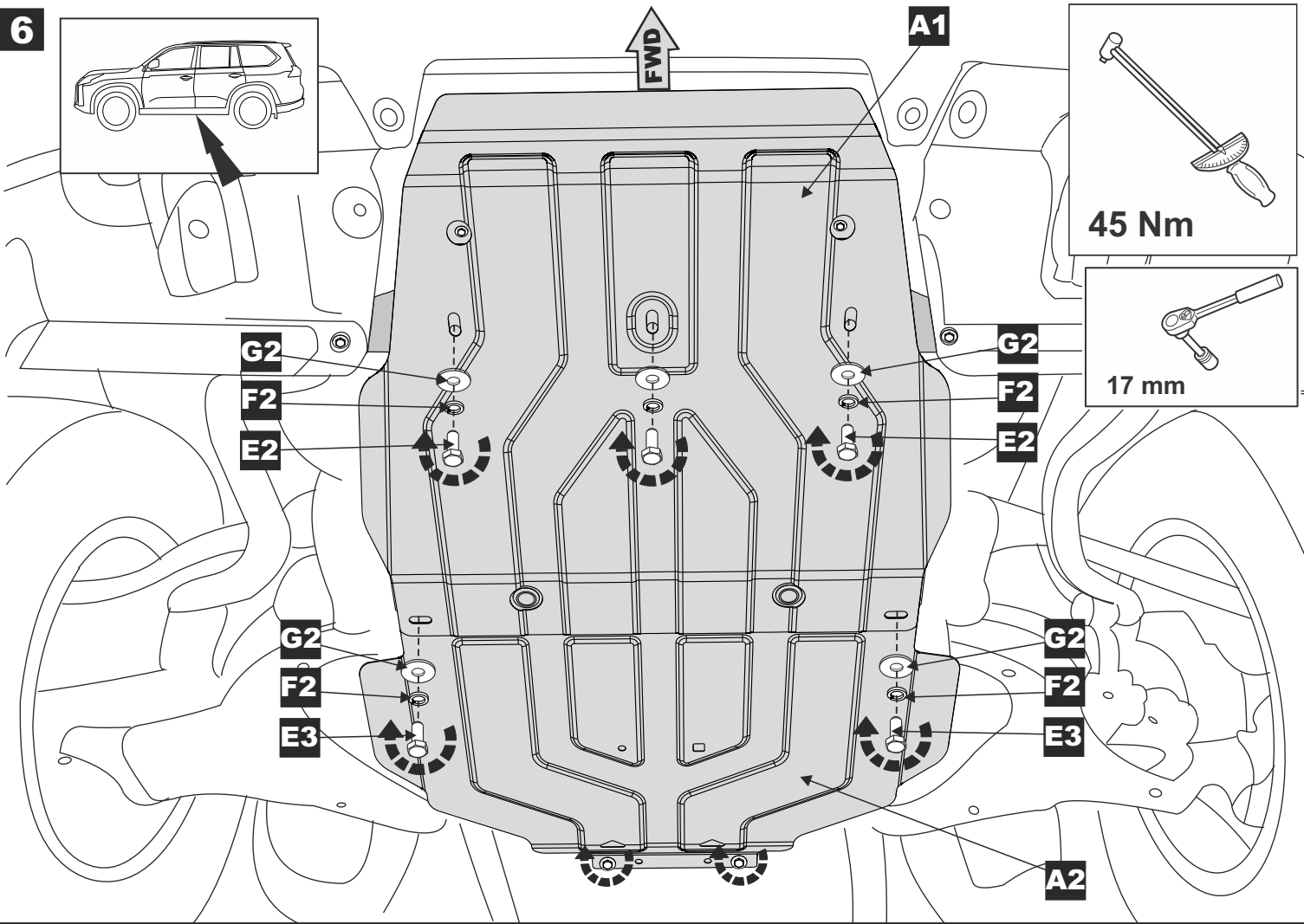

7

